

This example uses shape code 51,
to find alternative Shape Codes
go to our web site:
www.24r.co.uk
or call : 01895 430396
Email : hugh@24r.co.uk

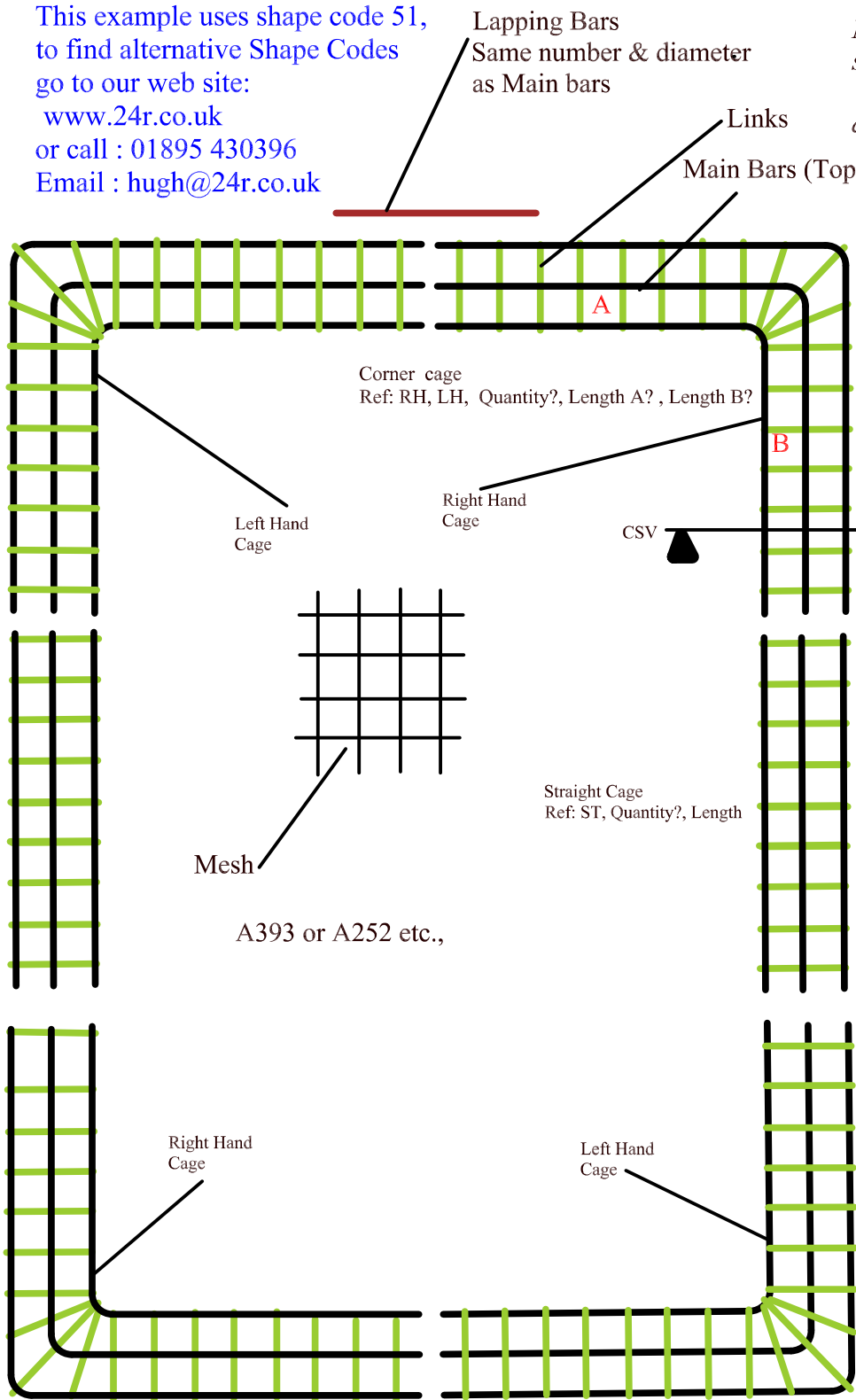

Note. When forming a square or rectangle, slab corner cages which are the same hand (eg., right hand) are normally placed diagonally opposite to each other.

Cross Section View

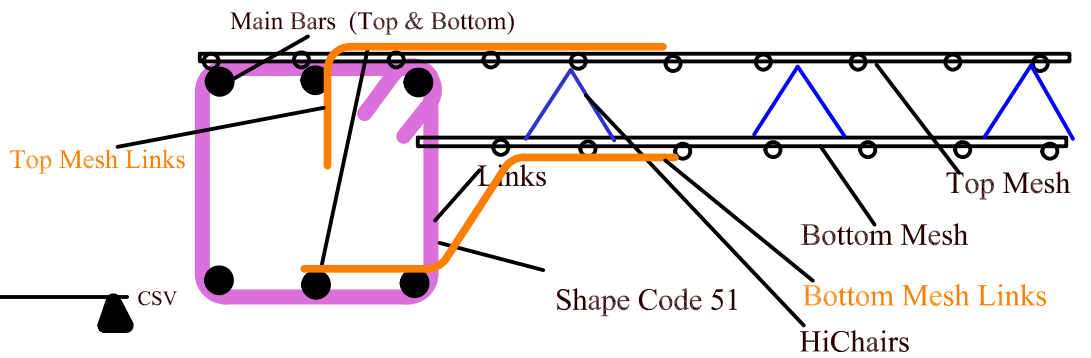

Details of information required when ordering steel for a raft.

1. Profile and outside dimensions of trench.
(width + depth + lengths outside to outside of trench)
2. Concrete cover required on cage.
3. Link dimensions eg., Shape code 51 sizes for A (height) B (width)
4. Link centres e.g., 150mm - 300mm
5. Link bar diameter
6. Main Bar diameters
7. Number of main bars top & Bottom

Because our cages feature continious main bars around the corner cages U's (shape code 21) are normally not required, however some SE's may still demand them, if this is the case then the size and diameter of the U's will be required.

Cages

Number and type of cages required eg., 2 right hand cages , 2Left hand Cages and 2 straight cages. Corner cages must be between 1.5M and 3M each side though side lengths may not match.

U's will always be required where one cage Tee's into another cage. When a cage Tee's into another cage we will require the exact location of the centre of the Tee joint .

Note: Cross Bracing cages which are teed in often have a different specification to the main cages.

Example: For a 5M x 10M raft slab the following cages would be required.

- 2 off right hand corner cages measuring 3M on the vertical right and 2.5M on the horizontal
 - 2 off Left hand corner cages measuring 3M on the vertical Left and 2.5M on the horizontal
 - 2 off straight cages measuring 4M
- other assessories required would consist of Lapping bars, Shape code 26 mesh link bars, shape code 11 top mesh link bars A393 Mesh or similar as specified.
Tying wire, Concrete spacers for under the bottom mesh and cages.
HiChairs for between the Top and Bottom Mesh sheets sizes between 50mm and 250mm x 2M depending on the slab thickness